

POONA COUPLINGS
PVT. LTD.

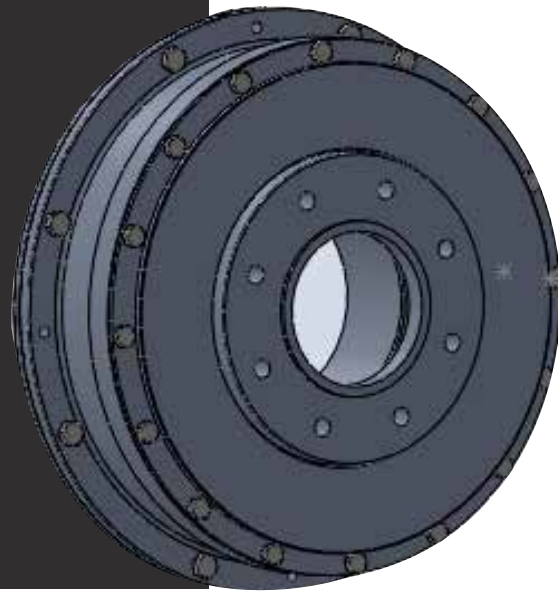

UNIVERSAL JOINT UJ

INDUSTRIAL RANGE

Features

- Intrinsically fail safe
- Control of resonant torsional vibration
- Severe shock load protection
- Maintenance free
- Introduces damping into the drive-line

Applications

- Railway Vehicles
- Construction Plants
- Marine Drives
- Pumps
- Paper Mills
- Steel Mills
- General Machinery
- Power Take Offs

Benefits

- Ensures continuous operation of the drive-line
- Achieves low vibratory loads in the drive-line components by selecting optimum stiffness characteristics
- Avoids failure of the drive-line under short circuit and other transient conditions
- No lubrication or adjustment is required resulting in low running costs.
- Reduces the vibratory torque in the drive-line and hence increases equipment life

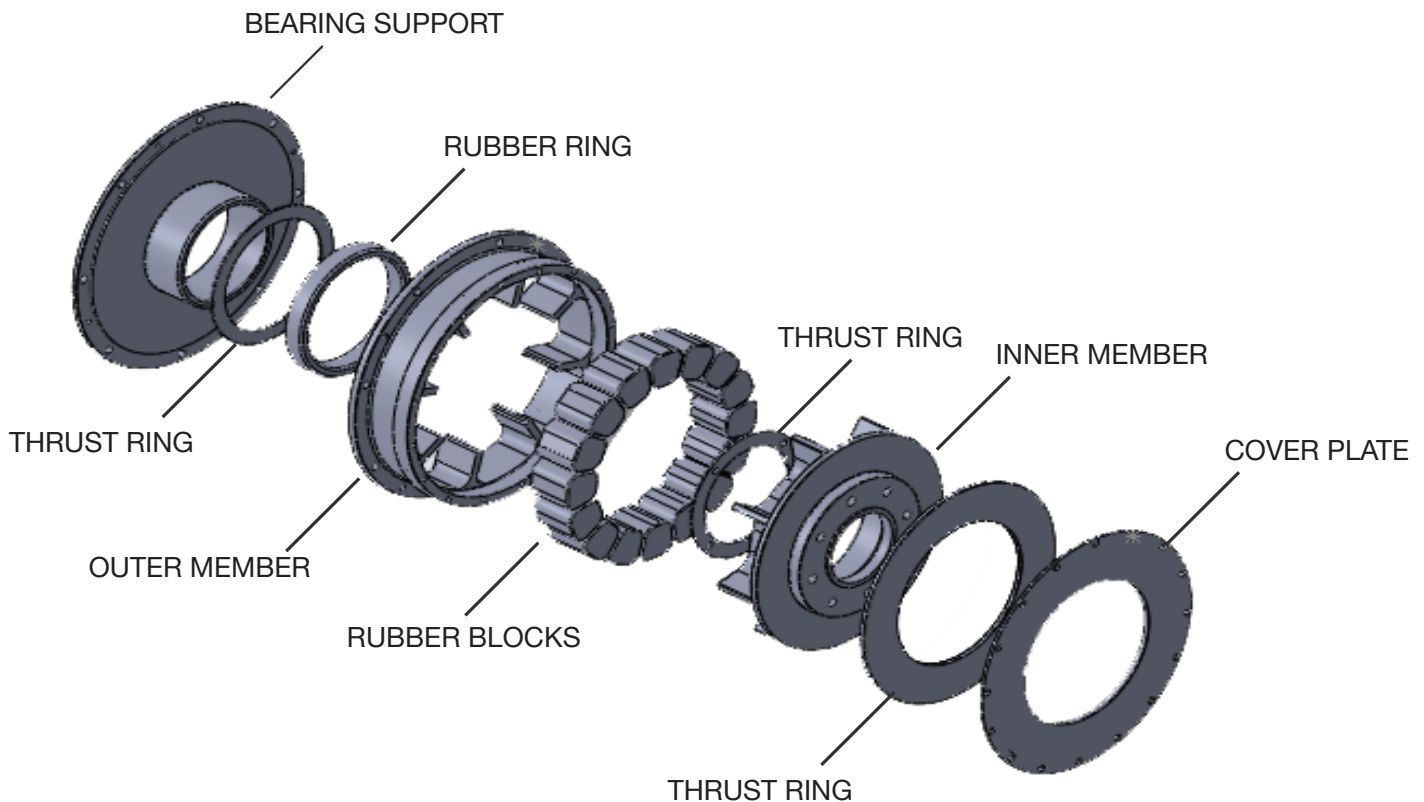

Note: Customised couplings can also be made for any application which requires an universal joint shaft to be connected.

UJ FLEXIBLE COUPLING DIMENSIONAL DATA

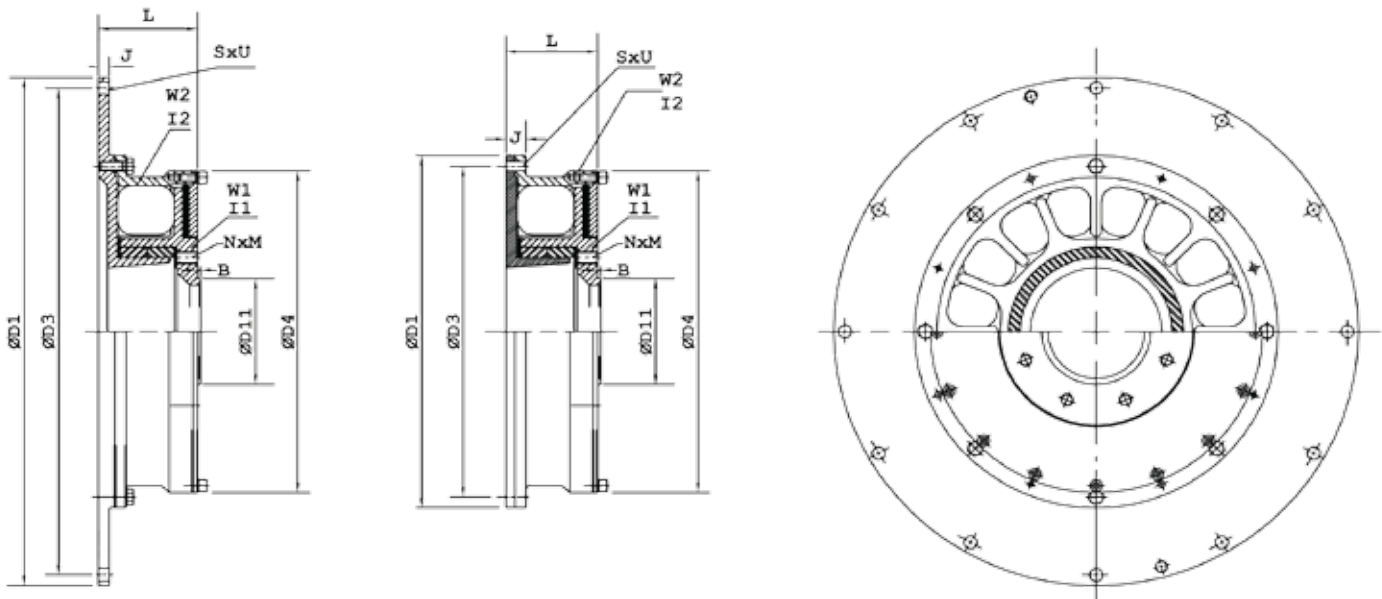

DIMENSIONAL DATA

COUPLING SIZE	UJ1500		UJ2000		UJ5000		UJ10000		UJ18000
	SAE 10	SAE 11.5	SAE 11.5	SAE 14	SAE 14	SAE 18	SAE 18	SAE 21	SAE 21
A	314.3	352.4	352.4	466.7	466.7	571.5	571.5	673.1	673.1
D	84.0	91.0	86.0	96.0	115.0	127.0	143.5	162.5	183.0
F	295.3	333.4	333.4	438.2	438.2	542.9	542.9	641.4	641.4
G	283.0	283.0	316.0	316.0	426.5	426.5	529.0	529.0	620.0
J	17.5	10.0	19.5	10.0	23.0	14.0	26.0	16.0	31.5
S	8	8	8	8	8	6	6	12	12
U	10.5	10.5	10.5	13.5	13.5	17.0	17.0	17.0	17.0
STANDARD FLANGE	DIN 150		DIN 180		DIN 225		DIN 250		DIN 285
N X M	8 X M12		10 X M16		8 X M16		8 X M18		8 X M20
B	2.3		2.5		4.0		4.0		5.7
C	90.0		110.0		140.0		140.0		175.0
WEIGHT W1	6.9		9.2		21.2		43.3		81.5
(KG) W2	17.2	21.2	23.1	41.9	52.5	66.8	90.3	114.2	162.3
INERTIA J1	0.05		0.08		0.38		1.18		3.00
(KGM²) J2	0.25	0.38	0.50	0.83	1.65	2.88	4.40	7.60	10.70

UJ FLEXIBLE COUPLING TECHNICAL DATA

TECHNICAL INFORMATION		UJ1500	UJ2000	UJ5000	UJ10000	UJ18000
Nominal Torque Tkn (kNm)		1.5	2.0	5.0	10.0	18.0
Maximum Torque Tkmax (kNm)		4.5	6.0	15.0	30.0	54.0
Vibratory Torque TkW (kNm)		0.50	0.66	1.66	3.33	6.00
Magnifier				3.5		
Allowable heat absorbed (w)		400	440	600	770	950
Maximum Speed (rpm)		3790	3345	2460	1985	1690
DYNAMIC TORSIONAL STIFFNESS MNm/rad		UJ1500	UJ2000	UJ5000	UJ10000	UJ18000
10 % Tkn	SM50	0.040	0.055	0.137	0.275	0.490
	SM60	0.050	0.068	0.170	0.335	0.610
	SM70	0.080	0.107	0.270	0.535	0.965
25 % Tkn	SM50	0.045	0.060	0.145	0.290	0.525
	SM60	0.052	0.070	0.172	0.340	0.615
	SM70	0.082	0.110	0.275	0.540	0.970
50 % Tkn	SM50	0.580	0.077	0.195	0.385	0.695
	SM60	0.065	0.085	0.215	0.425	0.770
	SM70	0.090	0.125	0.305	0.610	1.100
75 % Tkn	SM50	0.085	0.112	0.280	0.560	1.005
	SM60	0.092	0.125	0.305	0.615	1.100
	SM70	0.115	0.150	0.380	0.760	1.370
100 % Tkn	SM50	0.122	0.162	0.405	0.810	1.460
	SM60	0.135	0.180	0.450	0.900	1.620
	SM70	0.150	0.200	0.500	0.990	1.785

FLANGE OPTION	UJ1500	UJ2000	UJ5000	UJ10000	UJ18000
MECHANICS JOINT	4c	7c	8c	8c	-
	5c	8c	8.5c	8.5c	
	6c		9c	9c	
DIN FLANGE	90	120 - 8 x M10	150 - 8 X M12	-	
	100	120 - 8 X M8	150 - 8 X M10	-	250
	120 - 8 X M10	150 - 8 X M12	180 - 8 X M14	225 - 8 X M16	*285 - 8 X M20
	120 - 8 X M8	150 - 8 X M10	180 - 10 X M16	225 - 12 X M16	315
	*150 - 8 X M12	180 - 8 X M14	*225 - 8 X M16	*250 - 8 X M18	350
150 - 8 X M 10	*180 - 10 X M16	225 - 12 X M16	-	-	
SAE FLANGE	-	-	1510	-	-
	-	1280	1550	-	-
	1310	1310	1610	1880	1950
	1350	1350	1710	1910	2050
	1410	1410	1760	-	-
	-	-	1810	-	-

ENGINEERED TO ORDER COUPLINGS (ETO)

We design and manufacture couplings to custom fit the drive and driven components for one to one replacement. Our engineering expertise create value added offering for the products by taking efforts to design, develop, analyse, engineer and test.

Engineered to Order Couplings (ETO):

- Cardan Shaft
- Spacers of various dimensions
- Floating / Long Shaft for large DBSE
- Brake Disc / Brake Drum
- Stub Shaft
- Limited End Float
- Underwater Coupling
- Shear Pin Device
- Long Boss Hubs for increased shaft engagement
- Splined Hub
- Special Adapters
- Slim Line
- Uni - Directional Couplings



PM 600 Spacer Coupling of 1200 mm dia used in a ball mill application for a gold mine in South Africa.



PM 27 Underwater Coupling with Shear Pin device on a river dredger in Greece.



Special RB 150 Coupling with splined hub for pump application.



PM 40 Cardan Shaft Coupling for fan drive where motor was coupled to VFD for power saving to replace fluid coupling. DBSE was more than 2 mtrs. This was for a steel plant.



High temperature blind assembly coupling.

GLOBAL PRESENCE

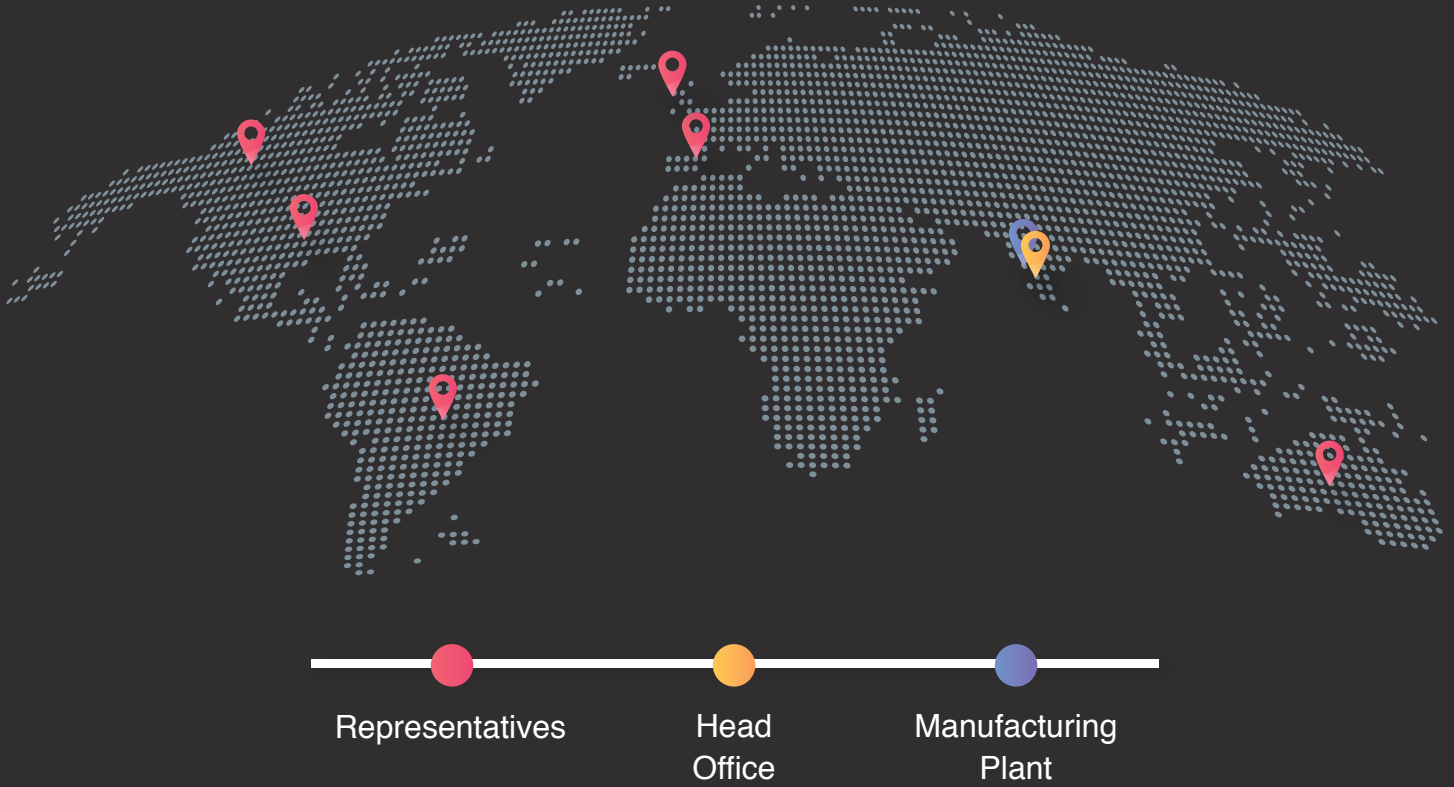

Regd Office: 'Sumali', 49/A/4 Erandwane,
Gulmohar Path, Pune, 411004, India



Works : Gat No. 106, At & Post Pirangut,
Taluka Mulshi, Dist. Pune 412108,
Maharashtra, India.



+ 91 8087090164 / 5



sales@poonacouplings.com
marketing@poonacouplings.com
www.poonacouplings.com